

1-9-88 "MEMORIES FROM A PICTURE".

MY FATHER DEVELOPED A CANCER ON HIS LOWER LIP IN 1933. AS THE CANCER BECAME WORSE FATHER HAD TO GIVE UP FARMING THE 80 ACRE FARM HE WAS RENTING FROM ORSON RICKS.

OUR FAMILY MOVED INTO THE OLD HINCKLEY FAMILY HOME WHICH WAS HOME FOR MY FATHER'S SISTER (HAZEL HINCKLEY MORRIS) AND HER TWO SONS LELAND AND SHELDON MORRIS AND MY FATHER'S BROTHER RICHARD (DICK) HINCKLEY.

MY FATHER (WILLIAM) SOON BECAME BED RIDDEN AND WAS CARED FOR BY MY MOTHER (MYRTLE HOLCOMB HINCKLEY) AND AUNT HAZEL.

UNCLE DICK DIED OF A HEART ATTACK AND IN THE EARLY SPRING OF 1936 MY FATHER DIED.

MOTHER AND MY SISTER (WILMA) AND I MOVED INTO A SMALL WOODEN, TWO ROOM HOME THAT WAS VACANT. IT WAS LOCATED ON THE ROAD THAT PARALLELED BY JOHNSON'S FARM. NEIGHBORS WERE THE WIDDISONS AND A.E. (SHERIFF) 'HANS' HANSEN.

MOTHER WAS A GOOD MANAGER AND FRIENDS, FAMILY & THE CHURCH HELPED AS NEEDS AROSE.

MEN HAULED PINE TREES FROM THE MOUNTAINS FOR FIRE WOOD. AN OLD MODEL 'A' FORD, CAR MOTOR WAS JAWY-RIGGED TO DRIVE A LARGE CIRCULAR SAW BLADE, WHICH THE MEN USED TO CUT ~~THE~~ THE PINE LOGS INTO STOVE LENGTH BLOCKS OF WOOD. MY JOB WAS TO SPLIT THE WOOD BLOCKS INTO STOVE WOOD SIZE PIECES AND TO CUT SOME OF THE STOVE WOOD PIECES INTO KINDLING TO USE IN STARTING FIRES. AFTER CUTTING THE WOOD I WOULD STACK IT AND KEEP THE LARGE WOOD BOX (IN BACK OF HER COOK STOVE) FILLED SO SHE HAD EASY ACCESS TO PLENTY OF DRY WOOD TO COOK WITH & HEAT OUR SMALL HOME.

I ALSO WAS RESPONSIBLE FOR KEEPING THE WATER RESERVOIR ON THE COOK STOVE (ABOUT 10 GALLON CAPACITY) FILLED WITH WATER. WATER WAS OBTAINED FROM A HAND OPERATED PUMP WHICH, IN TURN, WAS LOCATED IN A PUMP HOUSE.

ONE ROOM OF OUR HOUSE WAS FOR WASHING FACE & HANDS, COOKING, EATING, COATS AND HATS (HANGING AND STORING FOOD, DISHES & TABLE CLOTHES, DISH-TOWEL ETC.



Nothing makes a boy smarter than being a grandson.

-ANONYMOUS

MORE →

A grandmother corrects your grammar and wipes imaginary dirt from your cheeks.

—SARA SPURRIER (Age 12)
English youngster

THE OTHER ROOM (A WEE BIT LARGER BECAUSE IT WAS LONGER) CONTAINED TWO BEDS (MOTHER AND MY SISTER WILMA SLEPT IN ONE BED & I SLEPT IN THE OTHER). ONE CORNER HAD BEEN FRAMED TO SERVE AS A CLOSET. IT WAS ABOUT 3'X3' AND MOTHER HAD PUT CURTAIN RODS AT THE TOP AND HUNG MATERIAL (CLOTH) DOWN THE TWO SIDES TO MAKE THE CLOSET "PRIVATE" AND KEEP DUST FROM "SETTLING" ON THE FEW THINGS HUNG AND STORED THEIR IN PAPER BOXES. IN ADDITION TO THE TWO BEDS THERE WAS A ROUND, OAK, EXPANDABLE TABLE (IT HAD EAGLE CLAW FEET GRASPING WOODEN BALLS, ON WHICH IT SAT. THERE WERE 4 WOODEN CHAIRS AROUND IT.

THE FIRST ROOM I MENTIONED HAD A WOOD BURNING COOK STOVE, A WASH STAND, A COAT RACK, A PANTRY CABINET, A KITCHEN TABLE (COVERED WITH OIL CLOTH) 3 WOODEN CHAIRS AROUND THE TABLE. AND, A KITCHEN CABINET FOR DISHES, SPICES, DISH (WASH) CLOTHS, DISH (DRYING) TOWELS, A SMALL BENCH AND THE FIRST RADIO (BATTERY POWERED — WE HAD NO ELECTRICITY) WE EVER OWNED SAT ON TOP OF IT.

I HAD MY FIRST SHOTGUN — A 410 GAUGE SINGLE SHOT — THAT I USED TO BRING DUCKS, PHEASANTS, SAGE HENS AND RABBITS HOME TO HELP KEEP "MEAT ON THE TABLE". FARMERS & FRIENDS WERE KIND TO "WIDOW HINCKLEY" AND HER TWO CHILDREN WILLIAM RUSSELL & WILMA. THEY KEPT A GOOD WOOD SUPPLY ON HAND FOR ME TO CUT AND MOTHER TO USE. THEY GAVE US FRESH CIDER FROM THEIR APPLE ORCHARDS.

WHEN THEY BUTCHERED THEY GAVE US PIECES OF

MORE →

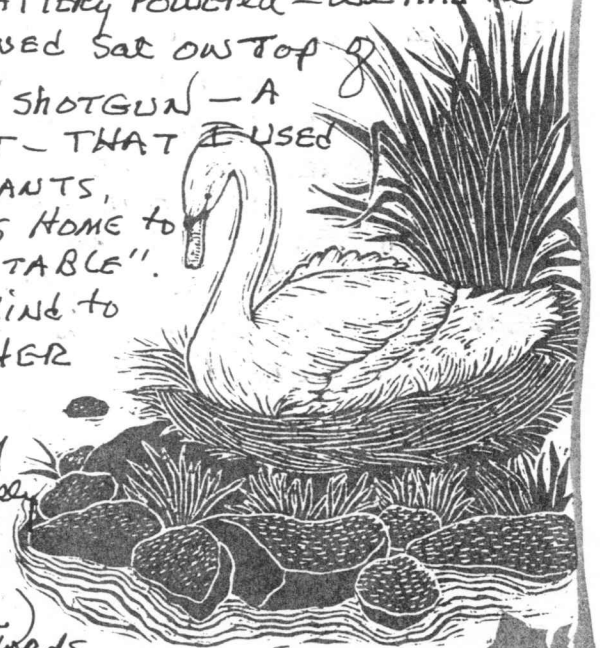



Praise youth and it will prosper.

—IRISH PROVERB

BEER & HOG (Pig). THEY WOULD ALSO STOP BY THE HOME AND GIVE "MYRTLE AND HER CHILDREN" RIDES INTO REKBURG, IDAHO (THE COUNTY SEAT OF MADISON COUNTY) SO SHE COULD BUY "STAPLES" (FLOUR, SEASONINGS, SUGAR, SALT, CANNED ITEMS AND CLOTH WITH WHICH TO MAKE CLOTHING FOR THE FAMILY.) THEY WOULD PLOW A GARDEN PLOT IN THE SPRING WHICH MOTHER PLANTED AND I WAS EXPECTED TO KEEP WEEDS.

WE WERE GIVEN A COW WHICH I MILKED FOR OUR CONSUMPTION... FRESH DRINKING MILK BUTTER, HOME MADE COTTAGE CHEESE AND SOUR AND CLABBER MILK FOR COOKING. WE HAD A FRUIT & VEGETABLE PIT IN WHICH APPLES, SQUASH, DRIED FRUITS & VEGETABLES IN MASON JARS AND "CANNED" FRUITS, JELLY, VEGETABLES AND MEAT (IN MASON JARS) WERE STORED IN THE WINTER SO THEY WOULDN'T FREEZE. FRESH STORED EGGS WERE ALSO KEPT IN THIS PIT. CHICKENS WOULDN'T LAY IN THE WINTER TIME SO SURPLUS FALL EGGS WERE WIPED WITH A DRY, CLEAN CLOTH AND THEN EACH EGG'S SHELL WAS COVERED (BY HAND) WITH LARD... PIG FAT RENDERED OUT AT FALL BUTCHERING TIME. A SQUARE, 5 GALLON TIN CAN WITH ITS TOP CUT OUT BECAME THE STORAGE CONTAINER FOR THE EGGS. ABOUT TWO INCHES OF CRASHED OATS WERE PLACED IN THE BOTTOM OF THE CAN, THEN EGGS WERE STOOD IN THE OATS WITH NO EGGS BEING ALLOWED TO TOUCH ANOTHER EGG OR THE INSIDE OF THE METAL CAN. THOSE EGGS WERE COVERED WITH OATS AND ANOTHER LAYER OF EGGS WERE ADDED UNTIL THE CAN WAS FILLED. THIS WAS OUR EGG SUPPLY FOR THE WINTER MONTHS. TOWARD SPRING THEY BEGAN TO LOSE THEIR FRESHNESS AND WERE USED IN COOKING RATHER THAN CONSUMED AS BREAKFAST EGGS. WE LIVED ON THE JOHNSON PLACE FOR ABOUT 2 1/2 YEARS... MY FRESHMAN & SOPHOMORE YEARS AT MADISON HIGH SCHOOL IN REKBURG, IDAHO

MORE

AND THE TWO SUMMERS ON EITHER END OF THOSE TWO SCHOOL YEARS. HERE IS A MAP OF HIBBARD - MY WORLD.

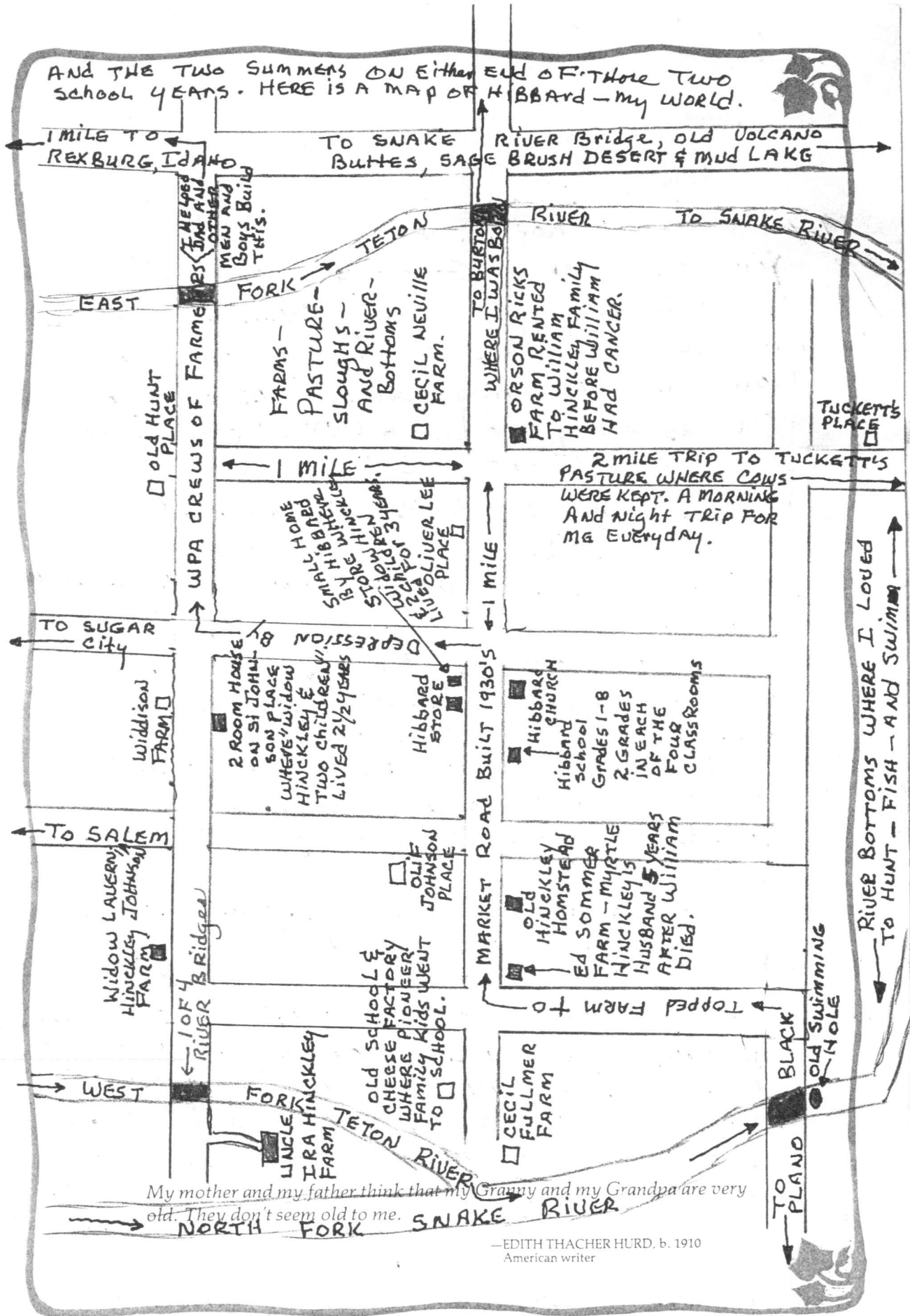

My mother and my father think that my Granny and my Grandpa are very old. They don't seem old to me.

-EDITH THACHER HURD, b. 1910
American writer